

REVISION		DESCRIPTION	DATE	APPROVED
ZONE	REV			

design & manufacture standard:

Design Manufacture As Per: Api 602 Bs5352 Asme B16.34
 Connection Ends Dimension As Per: asme B16.5 Asme B16.25
 Inspection And Test As Api 598

Class800 Main Outline Dimensions & Weight

Weld joint valve cover, outside screw stem & yoke (OS&Y).
 Designs according to BS5,352.

R.P	-	1/2	3/4	1	1 1/4	1 1/2	2	2 1/2
F.P	1/4	3/8	1/2	3/4	1	1 1/4	1 1/2	2
L	79	79	92	111	120	152	172	200
W	100	100	100	125	160	160	180	200
H	164	164	164	203	224	260	300	355
d	7	9	13	17.5	23	30	35	46
Weight(kg)	1.7	1.7	1.9	3.3	5.2	6.8	10.6	13.8

Class900~1500 Main Outline Dimensions & Weight

Weld joint valve cover, outside screw stem & yoke (OS&Y).
 Designs according to BS5,352.

R.P	-	1/2	3/4	1	1 1/4	1 1/2	2	2 1/2
F.P	1/4	3/8	1/2	3/4	1	1 1/4	1 1/2	2
L	92	111	111	120	152	172	200	220
W	100	125	125	160	160	180	200	240
H	171	207	207	240	258	330	355	370
d	7	12	15	20	28	32	40	45
Weight(kg)	2.0	3.4	3.3	6.0	5.6	10.3	14.2	18.5

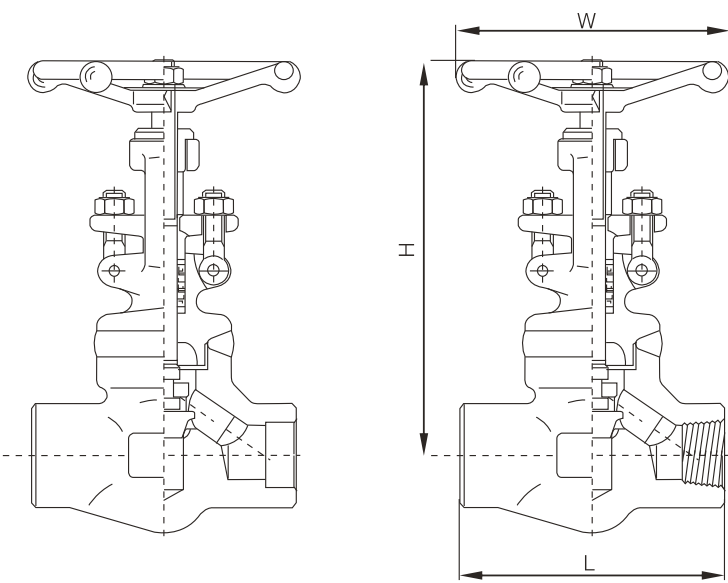

TOLERANCE
 UNLESS OTHERWISE SPECIFIED
 DECIMALS: .0 ± .1
 .00 ± .01
 .000 ± .005
 ANGLES: MACH. ±1'00"
 FORMED ±2"
 FRACTIONS: ±1/16"
 APPROVED BY
 BOND
 CHECKED BY
 JULIA
 DRAWING BY
 C L

科威納 | COVNA® VALVE COVNA GROUP CO.,LTD

TITLE
AMERICAN STANDARD STEEL GLOBE VALVE

FSCM: _____ DWG NO. _____ REV
A

SIZE mm SCALE SHEET SHEET 1 OF 1