

# COVNA AUTOMATION INDUSTRY CO., LTD.

## HK0018 Sanitary solenoid valve

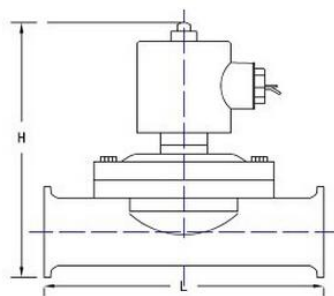

<b>General application category</b>		<b>Sheet</b>	
Sanitary solenoid valve is widely used in industrial fields dairy products, beer, food, pharmaceutical, beverage and biological		Temperature: -10℃~80℃,-20℃~180℃	
		Pressure: 0~16bar	
		Working type: Normally open/Close	
		Material: SS304、SS316	
		Sealing: NBR、PTFE.EPDM,Silicone	
<b>function-option</b>		<b>electrical characteristics</b>	
<b>No.</b>	<b>function</b>	<b>Coil:</b> AC220V 380V 110V 24V DC24V 12V	
NO	Normally Close	<b>Rated power:</b>	
K	Normally open	DN15-20mm AC 26VA,DC 18W	
E	explosion-proof	DN25-50mm AC 28VA,DC 38W	



<b>Specification sheet</b>							
Model	通径 mm	Cv 值	L	H	W	Clamp dia	Pressure (bar)
HK0018-15	15	4.8	95	100	55	34	0~16
HK0018-20	20	7.5	101	105	55	50.5	0~16
HK0018-25	25	12	140	120	78	50.5	0~16
HK0018-32	32	24	158	150	95	50.5	0~16
HK0018-40	40	29	160	164	95	64	0~16
HK0018-50	50	48	200	178	123	77.5	0~16