

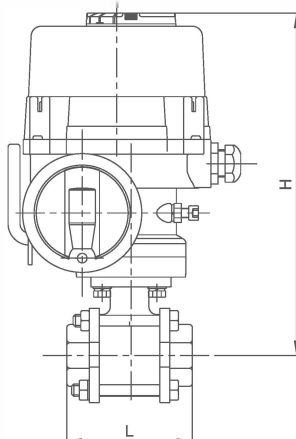

Nominal diameter DN(mm)		DN10~DN100					
Nominal pressure		PN 1.6/2.5/6.4MPa					
End connection		thread			Butt welded		
Main Parts	Valve body, valve cap	WCB	CF8(304)	CF8M(316)	WCB	CF8(304)	CF8M(316)
	Valve ball, valve stem	2Cr13	304	316	2Cr13	304	316
	O-ring, Packing	RPTFE、PPL					
Applicable Operating Condition	Applicable medium	Water, steam, oils	Nitric acid and other corrosive medium	Nitric acid and other corrosive medium	Water, steam, oils	Nitric acid and other corrosive medium	Nitric acid and other corrosive medium
	Suitable temperature	-29°C~180°C (RPTFE)、-29°C~300°C(PPL)					

Product description

Integrated structure electric three-piece ball valve match with LQ Electric actuator, and can be run with input(4~20mADC, 0~10VDC or 1~5VDC) signals or single-phase power. With the function of small volume, flow capacity, high regulation precision, good sealing, and light weight, etc. The valve is widely used in food, environmental protection, light industry, petroleum, paper, chemicals, teaching and research equipment, and electric power industries of industrial automation control systems.

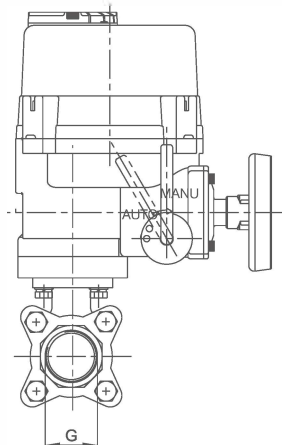

Product features

Thread and butt welded connection ball valve can be divided into 1-piece, 2-piece, 3-piece. Body cast adopt the advanced technology from Taiwan, with reasonable structure and beautiful shape. The elastic sealing structure make the seat reliable and easy to start. Valve stem seal downloading using inverted structure, The lower-loading Stem with backward sealing construction not only prevents the handle from backing-out but also ensures the reliability of the scaling part of the handle. There is butt weld(BW), socket welding(SW) connection of the 2-piece, 3-piece ball valve, and can match with the international standard ISO platform and locking devices.

Electric threaded ball valve (standard type) dimensions

SIZE		Item	H	L
mm	inch(G)			
20	3/4"	COVNA-QT10	316	85
25	1"		320	90
32	1 1/4"		330	112
40	1 1/2"		351	120
50	2"	COVNA-QT10	362	145
65	2 1/2"	COVNA-QT15	401	170
80	3"	COVNA-QT20	472	200
100	4"	COVNA-QT50	547	263

Note: Above table size is not with standard parts, there may be some changes in the data due to product innovation and improved technology, the specific details please consult salesman.